

- NOTES:**
 1-FRAME TO BE SQUARE, FLAT AND TRUE.
 2-STRUCTURAL STEEL SHALL BE A.S.T.M. A-36
 3-FRAME TO BE GALVANIZED AFTER FABRICATION IN ACCORDANCE WITH A.S.T.M. A-123.
 4-APPROXIMATE WEIGHT AFTER GALVANIZED: 214 LBS.

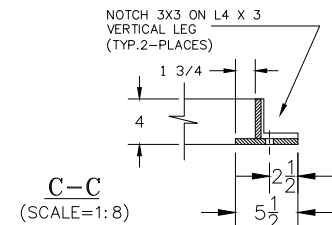
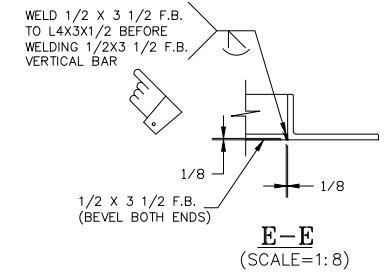
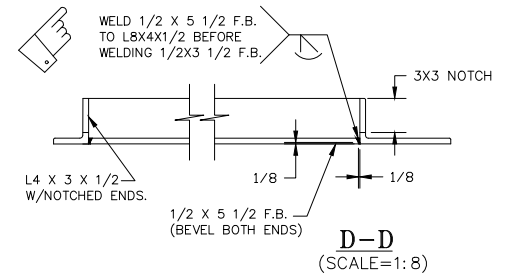

THIS DOCUMENT IS THE PROPERTY OF U.S.F. FABRICATION, INC AND CONTAINS PROPRIETARY INFORMATION. IT SHALL NOT BE MODIFIED, COPIED, FURNISHED NOR DISTRIBUTED (IN WHOLE OR IN PART) WITHOUT PROPER AUTHORIZATION OF U.S.F. FABRICATION, INC.

INTERPRET DIMENSIONS AND TOLERANCES PER ASME Y14.5M
BREAK ALL SHARP CORNERS & EDGES
TOLERANCES UNLESS OTHERWISE SPECIFIED:
INCHES AND FRACTIONS:
< 10' = ± 1/8
> 10' = ± 1/4

COPYRIGHT © 2020
ALL RIGHTS RESERVED

MARYLAND DEPARTMENT OF TRANSPORTATION



U.S.F. FABRICATION INC.
HIALEAH, FLORIDA

STANDARD SINGLE FRAME, STEEL
MODIFIED

DRAWN BY: A.Q.	SCALE: 1:16	SHEET: 1 OF 1	DATE: 07/27/20
APP'D BY: A.Q.	DWG. NO: 1000160183	SHEET SIZE: B	REV: 0